

## Features

### Specifications

Stainless Steel Thermodynamic Steam Trap with S.S. Trim and Strainer.

### End Connections

Screwed Female BSP Parallel Threads to BS 21.

### Test Pressures

600 Psig Hyd.

### Salient Features

- Fine finish Investment casting S.S.
- Screen is guided in the body.
- Corrosion Resistant screen is used..



## Suitability

Water

Steam

Gas

Oil

Air

## Material Combination

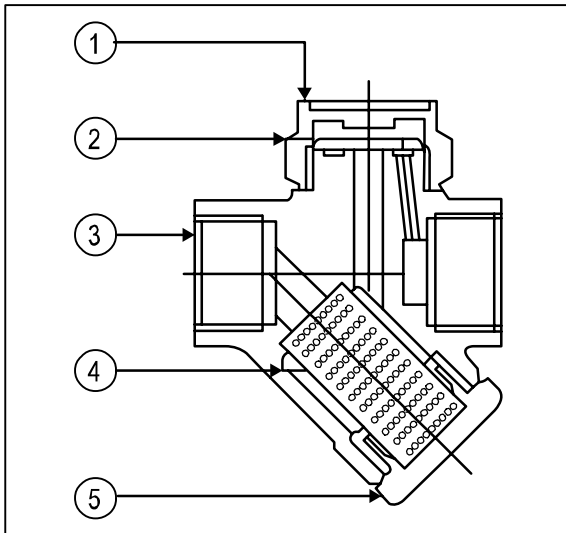

P/No.	Name of Part	Material	Specifications
1	Top Nut	S.S.	AISI 420
2	Disc	S.S.	AISI 410
3	Body	S.S.	AISI 420
4	Screen	S.S.	Type 304
5	Cover	S.S.	AISI 420

## Dimensional Data

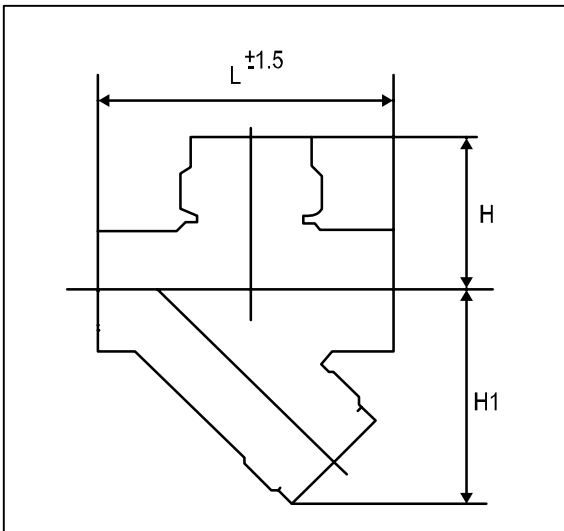

Nominal Size	L	H	H1
15	79	44	67
20	79	44	67
25	88	48	70